

Shakespeare Garden Masterplan

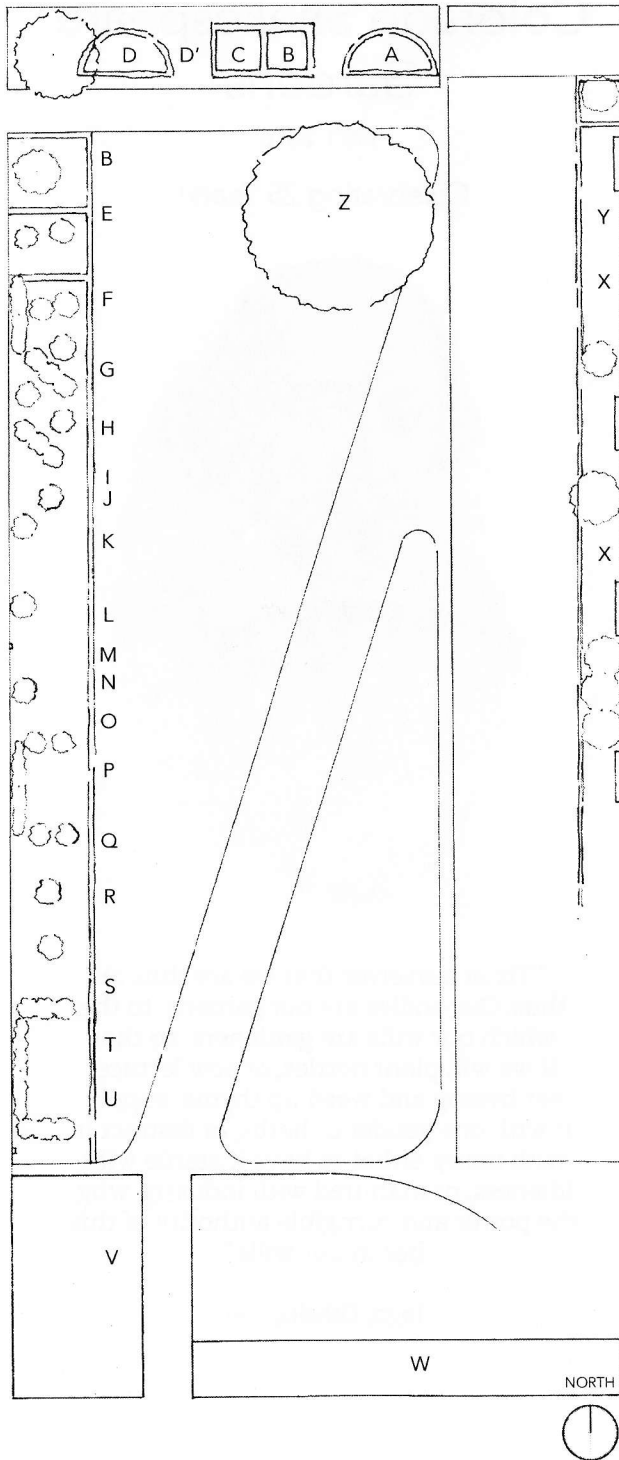

Index

- A Thyme Garden
- B Elizabethan Garden
- C Old Knot Garden (soon to be Cutting Garden)
- D Highlight Garden
- D' Plum Tree (part of the Highlight Garden)
- E Hamlet
- F Taming of the Shrew
- G Twelfth Night
- H Comedy of Errors
- I Love's Labour's Lost
- J Cymbelline
- K Antony and Cleopatra
- L Othello
- M As You Like It
- N Measure for Measure
- O King Lear
- P Romeo and Juliet
- Q All's Well That Ends Well
- R Winter's Tale
- S Much Ado About Nothing
- T The Tempest
- U Macbeth
- V Knot Garden
- W A Midsummer Night's Dream
- X The War of the Roses Garden
- Y The History Plays
- Z Marlene Cowdery Memory Tree

Highlight Garden: Current Year's Plays

A Comedy of Errors, Cymbeline, Henry VI part II,
Troilus and Cressida

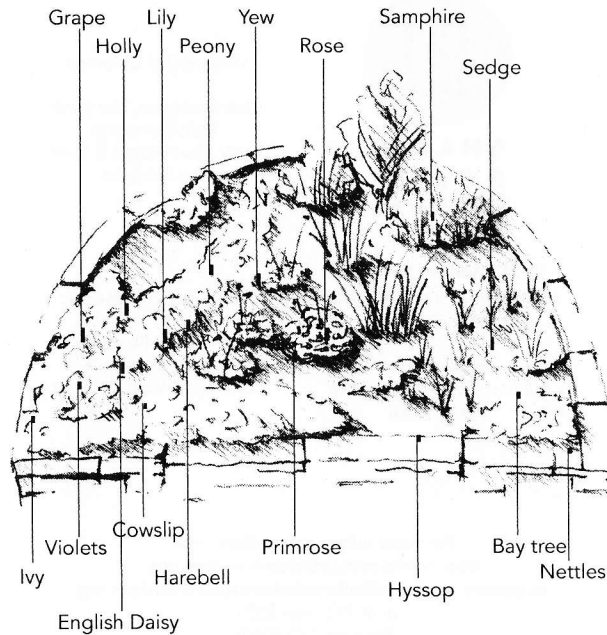

Knot Garden

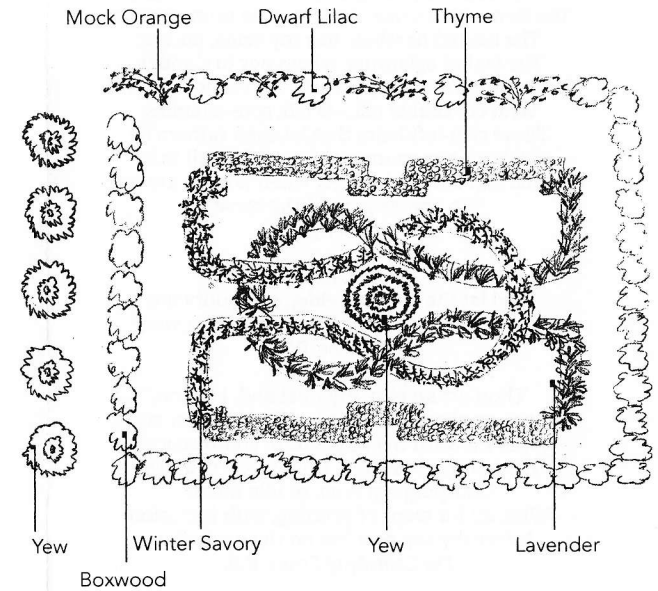

"It standeth North North-east and by East from the
West corner of thy curious knotted garden"
Love's Labours Lost, I. i

War of the Roses Garden

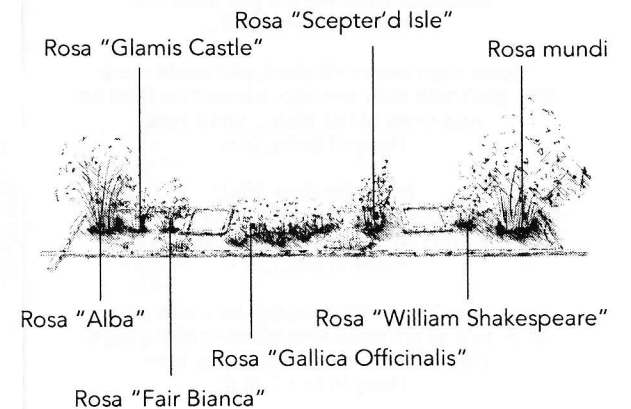

With fairest flowers
 Whilst summer lasts and I live here, Fidele,
 I'll sweeten thy sad grave: thou shalt not lack
 The flower that's like thy face, pale primrose, nor
 The azured harebell, like thy veins, no, nor
 The leaf of eglantine, whom not to slander,
 Out-sweeten'd not thy breath: the ruddock would,
 With charitable bill,--O bill, sore-shaming
 Those rich-left heirs that let their fathers lie
 Without a monument!--bring thee all this;
 Yea, and furr'd moss besides, when flowers are none,
 To winter-ground thy corse.
Cymbeline, IV.ii.

Grow, patience!
 And let the stinking elder, grief, untwine
 His perishing root with the increasing vine!
Cymbeline, IV.ii.

Thou art an elm, my husband, I a vine,
 Whose weakness, married to thy stronger state,
 Makes me with thy strength to communicate:
 If aught possess thee from me, it is dross,
 Usurping ivy, brier, or idle moss;
 Who, all for want of pruning, with intrusion
 Infect thy sap and live on thy confusion.
The Comedy of Errors, II.ii.

'Tis true; she rides me and I long for grass.
 'Tis so, I am an ass;
The Comedy of Errors, II.ii.

that same dog-fox, Ulysses, is
 not proved worthy a blackberry:
Troilus and Cressida, V.iv.

O, be thou my Charon,
 And give me swift transportance to those fields
 Where I may wallow in the lily-beds
 Proposed for the deserver!
Troilus and Cressida, III.ii.

Toadstool, learn me the proclamation.
Troilus and Cressida, II.i.

Some stern untutor'd churl, and noble stock
 Was graft with crab-tree slip; whose fruit thou art,
 And never of the Nevils' noble race.
Henry VI Part 2, III.ii.

Poison be their drink!
 Gall, worse than gall, the daintiest that they taste!
 Their sweetest shade a grove of cypress trees!
Henry VI Part 2, III.ii.

I would be blind with weeping, sick with groans,
 Look pale as primrose with blood-drinking sighs,
 And all to have the noble duke alive.
Henry VI Part 2, III.ii.

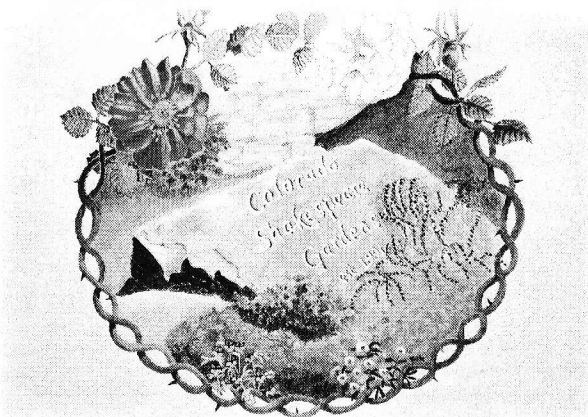

The Colorado Shakespeare Gardens were founded in 1991 by Marlene Cowdery, an avid gardener and Shakespeare buff, with the intent to educate the public about the many plants referenced by William Shakespeare in his plays. In addition to cultivating these gardens, the volunteer-based garden group provides free garden tours during the summer festival season, other public presentations, and published research.

We are actively looking for new members as well as sponsors to provide donations and support for the garden.

A Special Thanks to Our Sponsors:



University of Colorado

Chet Anderson, The Fresh
 Herb Company
 Kerry, Giambrocco & Sons
 The Tea Spot

**In Memoriam to those
 who have meant so much
 to the Garden:**

Jim Broaddus
 Marlene Cowdery, Founder
 Joe Van Zale

Acknowledgements:

Diana and Mike Kinsey
 Boulder County Jail
 Community Work Program

For more information, please visit
www.coloradoshakespearegardens.org,
 or contact us at info@coloradoshakespearegardens.org
 or at P.O. Box 20355
 Boulder, CO 80305

Colorado Shakespeare Gardens

1991-2016

Celebrating 25 Years!



"'Tis in ourselves that we are thus or
 thus. Our bodies are our gardens, to the
 which our wills are gardeners: so that
 if we will plant nettles, or sow lettuce,
 set hyssop and weed up thyme, supply
 it with one gender of herbs, or distract it
 with many, either to have it sterile with
 idleness, or manured with industry, why,
 the power and corrigible authority of this
 lies in our wills."

Iago, Othello, I. iii